

FLASHING COMPONENTS

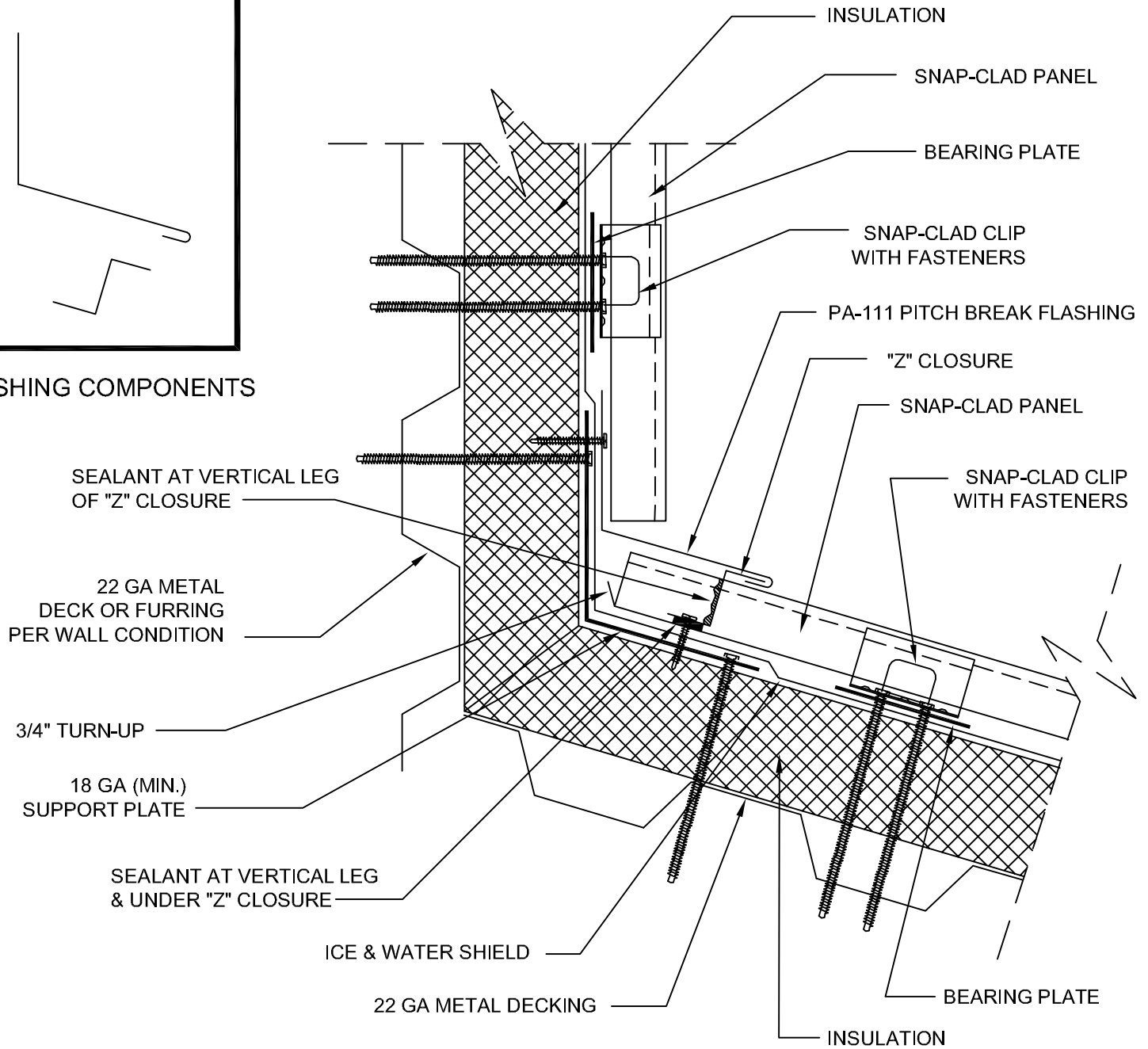

Job Name:	Notes:
Date:	
Contractor:	

REV. 05/19/2011

**PETERSEN ALUMINUM CORPORATION**

www.pac-clad.com / email: sales@petersenmail.com

HQ: 1005 Tonne Road  
Elk Grove Village, IL 60007  
P: 800-PAC-CLAD  
F: 800-722-7150

9060 Junction Drive  
Annapolis Junction, MD 20701  
P: 800-344-1400  
F: 301-953-7627

10551 PAC Road  
Tyler, TX 75707  
P: 800-441-8661  
F: 903-581-8592

350 73rd Ave., NE, Ste 1  
Fridley, MN 55432  
P: 877-571-2025  
F: 866-901-2935

102 Northpoint Pkwy Ext, Bldg 1, Ste 100  
Acworth, GA 30102  
P: 800-272-4482  
F: 770-420-2533