

12-20" COVERAGE



SHOWN WITH OPTIONAL FLAT RIB



SHOWN WITH OPTIONAL PENCIL RIBS



SHOWN WITH OPTIONAL STRIATIONS

EDGE LOC 1.5 INTERLOCK

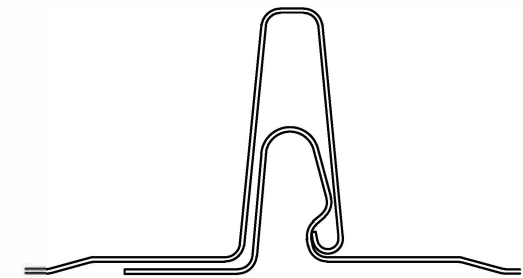

EDGE LOC 1.0 INTERLOCK

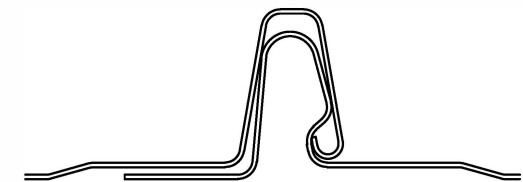

NOTE: Not all stiffening options are available at all locations - actual appearance may vary slightly.



PAC CLAD  
 PETERSEN ALUMINUM CORPORATION  
 102 NORTHPOINT PARKWAY, BLDG 102  
 ACWORTH, GA 30102  
 PH: 77-0427-6378 FAX: 770-420-2533

JOB  
**EDGE LOC PANEL**

DETAIL  
**PANEL PROFILE**

SCALE N.T.S.	ARCH REFERENCE N/A
FILE # DLT	DATE 04 DEC 2013

SHEET  
**A1**

FASTEN ROOF PANEL THROUGH SCREW SLOTS USING APPROPRIATE FASTENERS FOR THE UNDERLYING DECKING. DO NOT OVER-TORQUE SCREWS.

EDGE LOC ROOF PANEL.

UNDERLAYMENT.

DECKING.

INSTALLER TO FIELD NOTCH & FOLD PANEL UNDER 180°. HOOK PANEL ON EAVE FLASHING.

EAVE FLASHING & CLEAT. FASTEN CLEAT TO FASCIA W/ SCREWS 12" OC MAX. HOOK EAVE FLASHING ON CLEAT AT BOTTOM, THEN FASTEN AT TOP TO DECKING WITH SCREWS 12" OC MAX.

FASCIA.

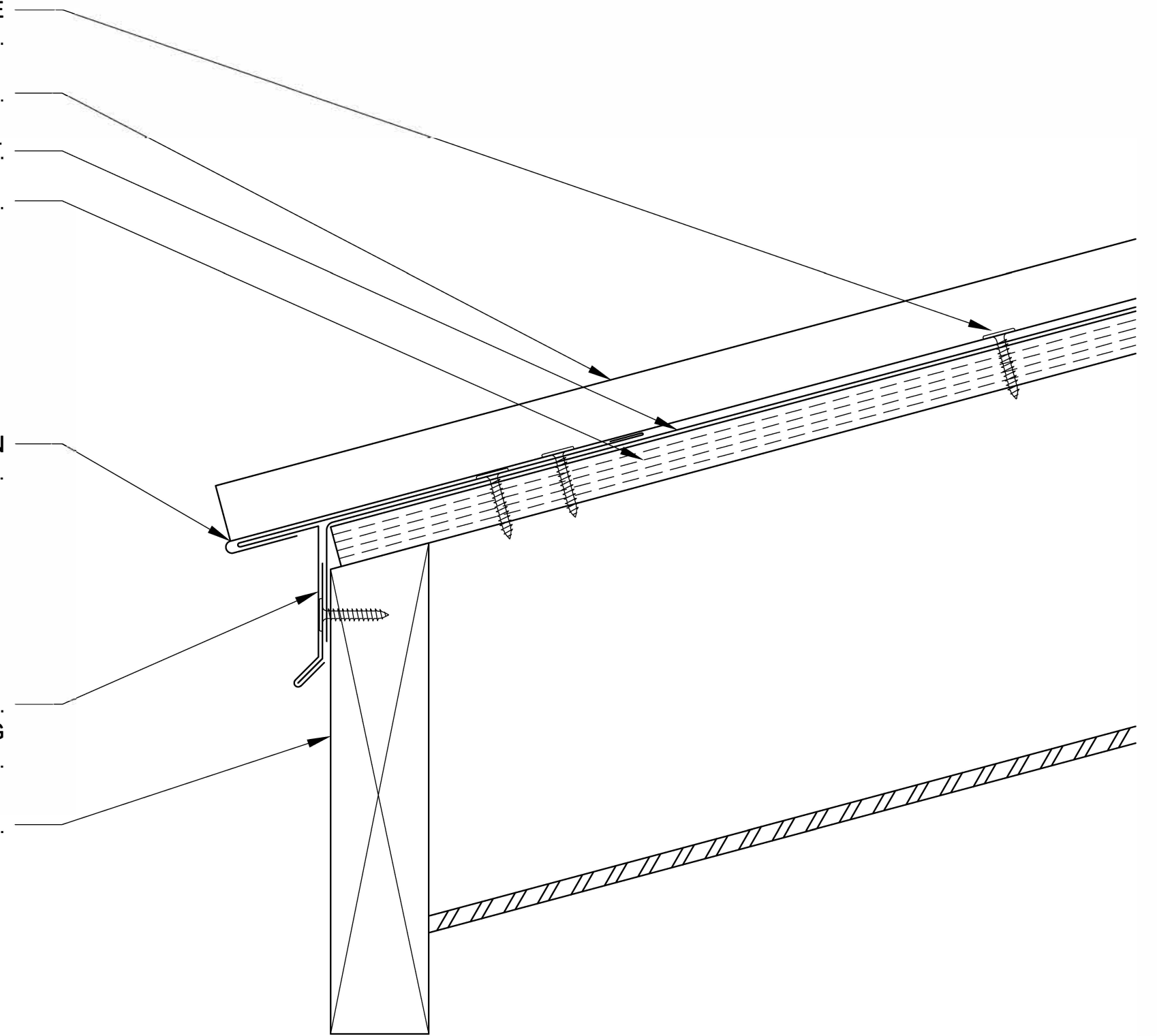

PAC CLAD  
 PETERSEN ALUMINUM CORPORATION  
 102 NORTHPOINT PARKWAY, BLDG 102  
 ACWORTH, GA 30102  
 PH: 77-0427-6378 FAX: 770-420-2533

JOB

# EDGE LOC PANEL

DETAIL

## EAVE SECTION

SCALE N.T.S.	ARCH REFERENCE N/A
FILE # DLT	DATE 04 DEC 2013

SHEET

# A2

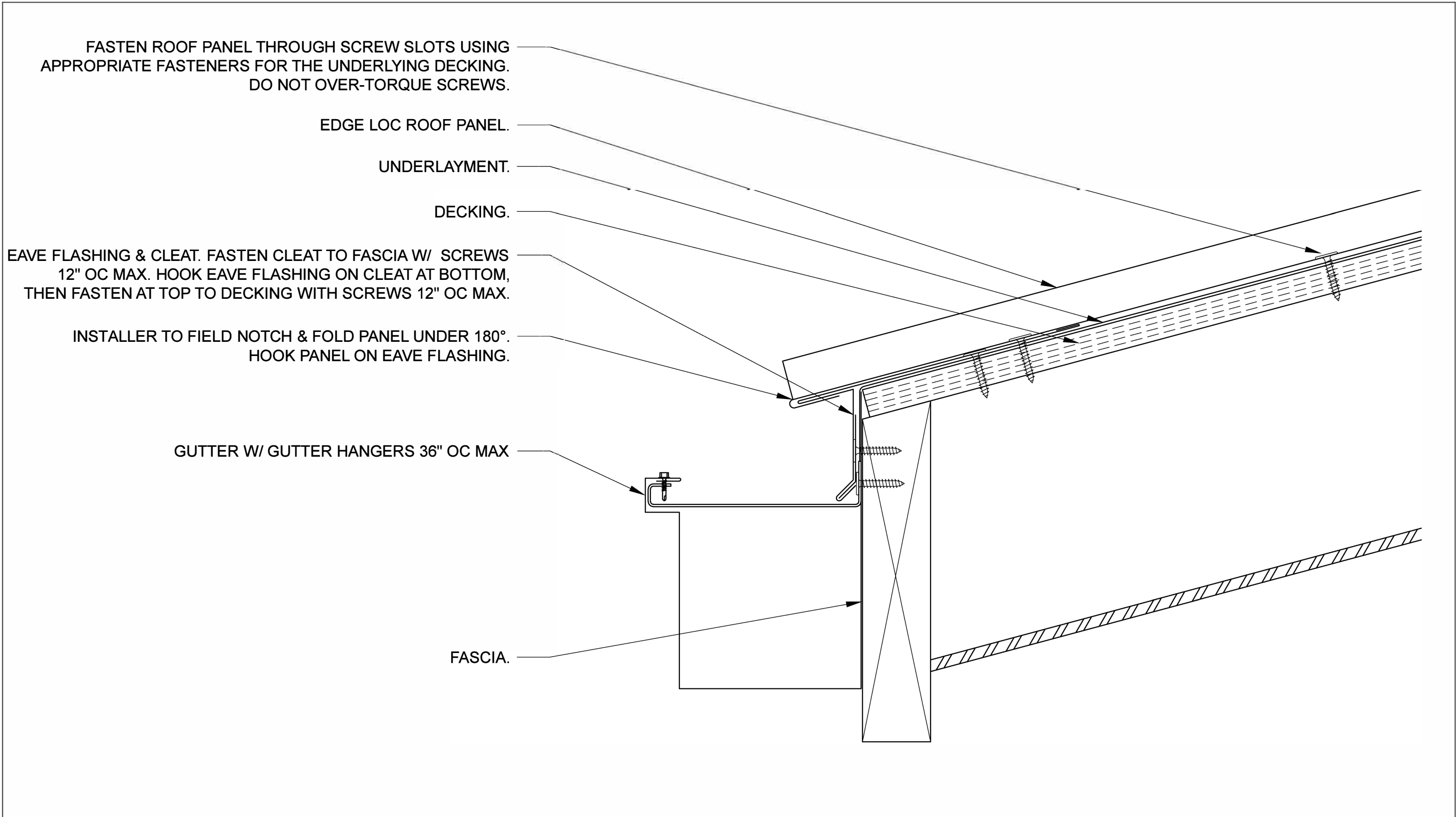



**PAC CLAD**  
 PETERSEN ALUMINUM CORPORATION  
 102 NORTHPOINT PARKWAY, BLDG 102  
 ACWORTH, GA 30102  
 PH: 77-0427-6378 FAX: 770-420-2533

JOB  
**EDGE LOC PANEL**

DETAIL	
<b>EAVE SECTION w/ GUTTER</b>	
SCALE N.T.S.	ARCH REFERENCE N/A
FILE # DLT	DATE 04 DEC 2013

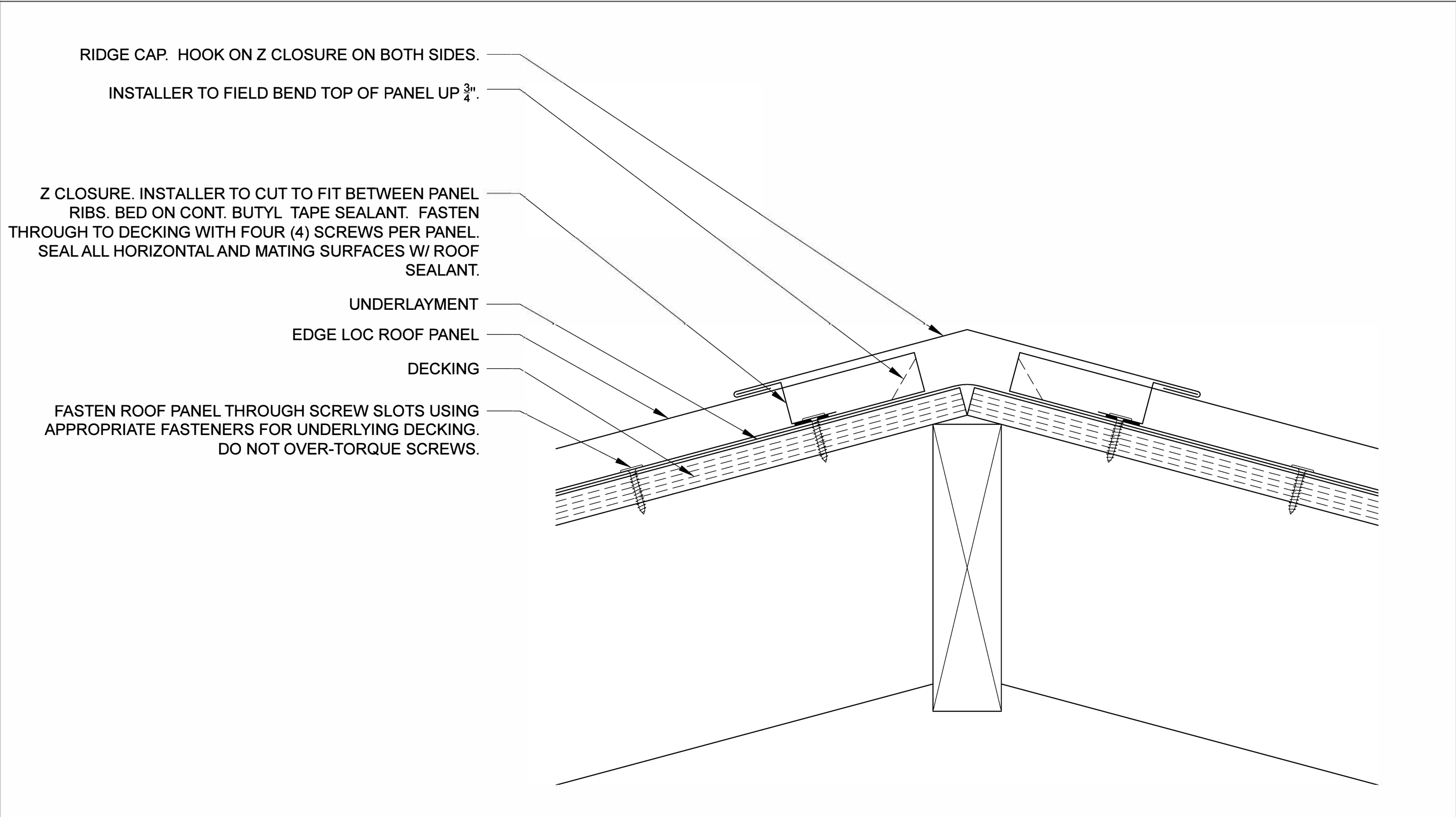
SHEET  
**A3**



EDGE LOC ROOF PANEL. FASTEN THROUGH SCREW SLOTS USING  
 APPROPRIATE FASTENERS FOR THE UNDERLYING DECKING.  
 DO NOT OVER-TORQUE SCREWS.

VALLEY CLEAT. BED ON CONT. BUTYL TAPE SEALANT. FASTEN THROUGH TO  
 DECKING W/ SCREWS 3" OC MAX

INSTALLER TO FIELD NOTCH & FOLD PANEL UNDER 180°. HOOK PANEL ON  
 VALLEY CLEAT

UNDERLAYMENT

DECKING

VALLEY FLASHING

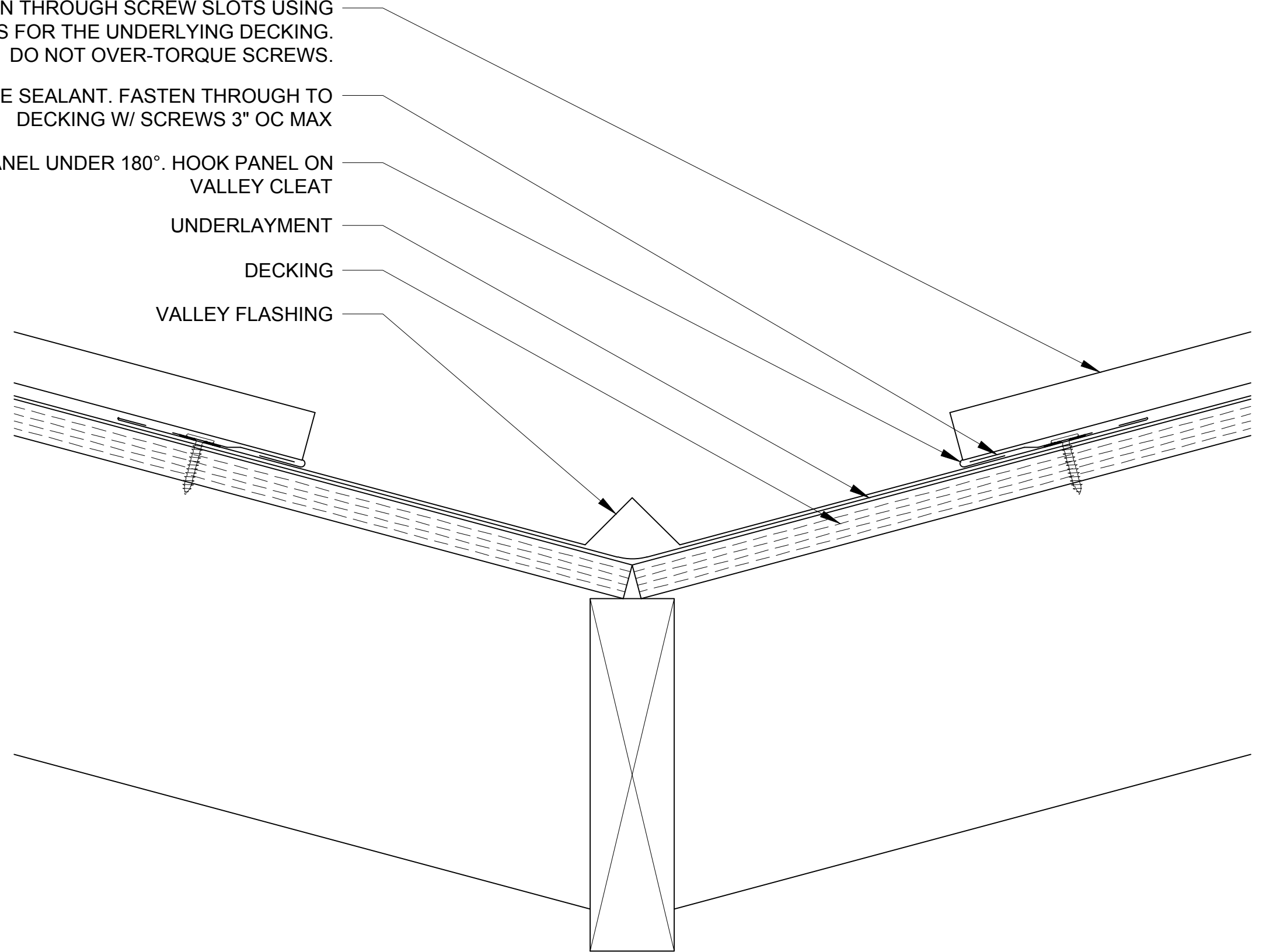

PAC CLAD  
 PETERSEN ALUMINUM CORPORATION  
 102 NORTHPOINT PARKWAY, BLDG 102  
 ACWORTH, GA 30102  
 PH: 77-0427-6378 FAX: 770-420-2533

JOB

# EDGE LOC PANEL

DETAIL

## VALLEY SECTION

SCALE  
 N.T.S.

ARCH REFERENCE  
 N/A

FILE #  
 DLT

DATE  
 04 DEC 2013

SHEET

# A5

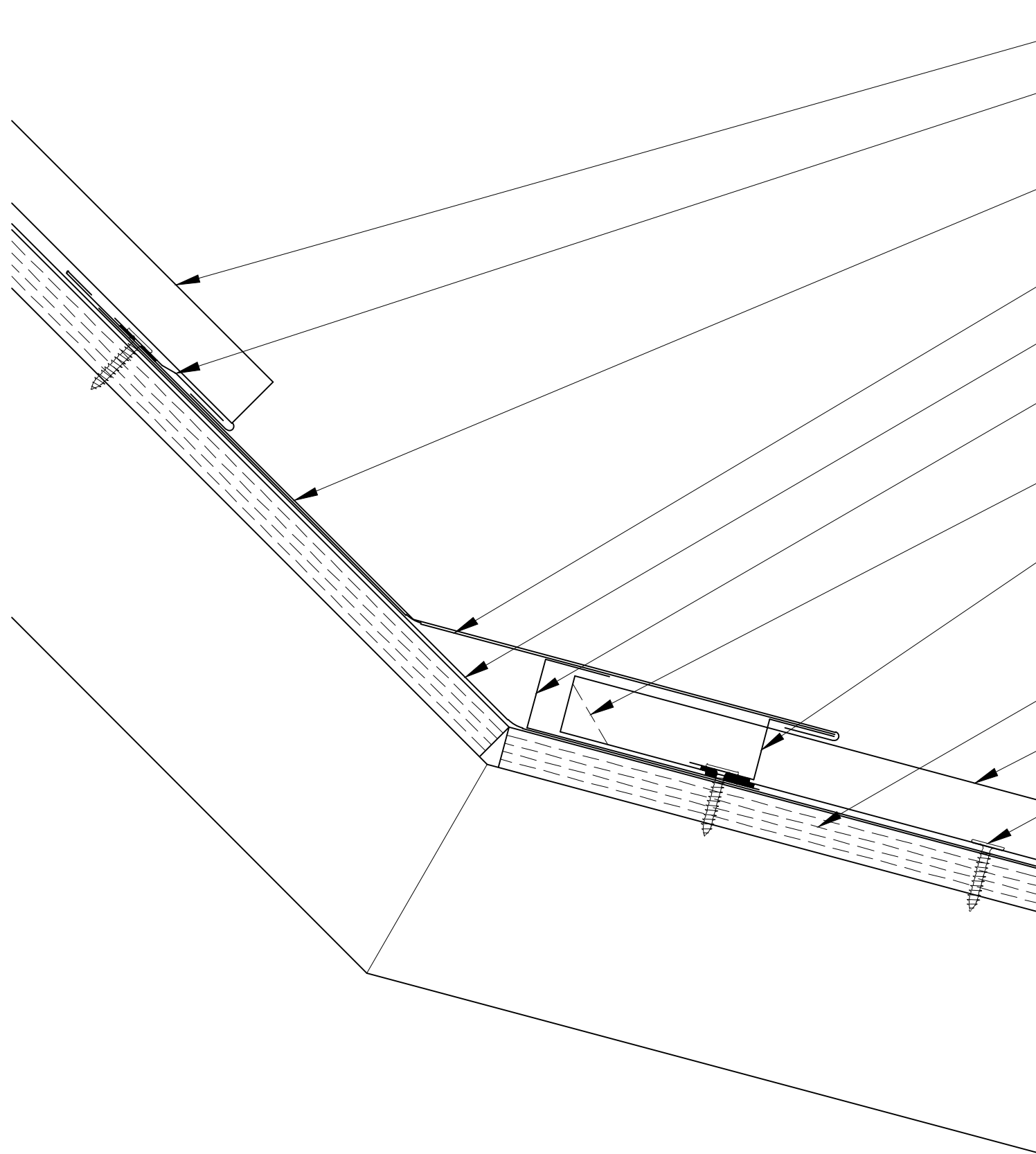

- EDGE LOC ROOF PANEL.
- JOGGLE CLEAT. BED ON CONT. BUTYL TAPE SEALANT. FASTEN THROUGH TO DECKING W/ APPROPRIATE FASTENER 3" OC MAX.
- PITCH TRANSITION FLASHING. HOOK ON Z CLOSURE ON LOWER ROOF. FASTEN THROUGH TO DECKING AT TOP.
- FLEXIBLE MEMBRANE LINER TO OVERLAP J CLOSURE & Z CLOSURE.
- UNDERLAYMENT
- HEAVY GAUGE STEEL J CLOSURE. FASTEN TO DECKING W/ APPROPRIATE SCREWS 12" OC.
- INSTALLER TO FIELD FOLD TOP OF PANEL UP  $\frac{3}{4}$ ".
- Z CLOSURE. INSTALLER TO CUT TO FIT BETWEEN PANEL RIBS. BED ON CONT. BUTYL TAPE SEALANT. FASTEN THROUGH TO DECKING W/ FOUR (4) SCREWS PER PANEL. SEAL ALL VERTICAL & HORIZONTAL MATING SURFACES W/ ROOF SEALANT.
- DECKING.
- EDGE LOC ROOF PANEL.
- FASTEN ROOF PANEL THROUGH SCREW SLOTS USING APPROPRIATE FASTENERS FOR THE UNDERLYING DECKING. DO NOT OVER-TORQUE SCREWS.

EDGE LOC ROOF PANEL. FASTEN THROUGH SCREW SLOTS USING APPROPRIATE FASTENERS FOR THE UNDERLYING DECKING. DO NOT OVER-TORQUE SCREWS.

INSTALLER TO FIELD CUT PANEL TO WIDTH AS REQUIRED. FOLD PANEL UP 90° TO FIT SNUGLY WITHIN J CLOSURE.

J CLOSURE. FASTEN TO DECKING W/ SCREWS 12" OC MAX.

UNDERLAYMENT TO TURN DOWN FACE BEHIND CLEAT.

GABLE FLASHING & CLEAT. FASTEN CLEAT TO FASCIA W/ SCREWS 12" OC MAX. HOOK GABLE FLASHING ON CLEAT AT BOTTOM & ON J CLOSURE AT TOP.

DECKING.

FASCIA.

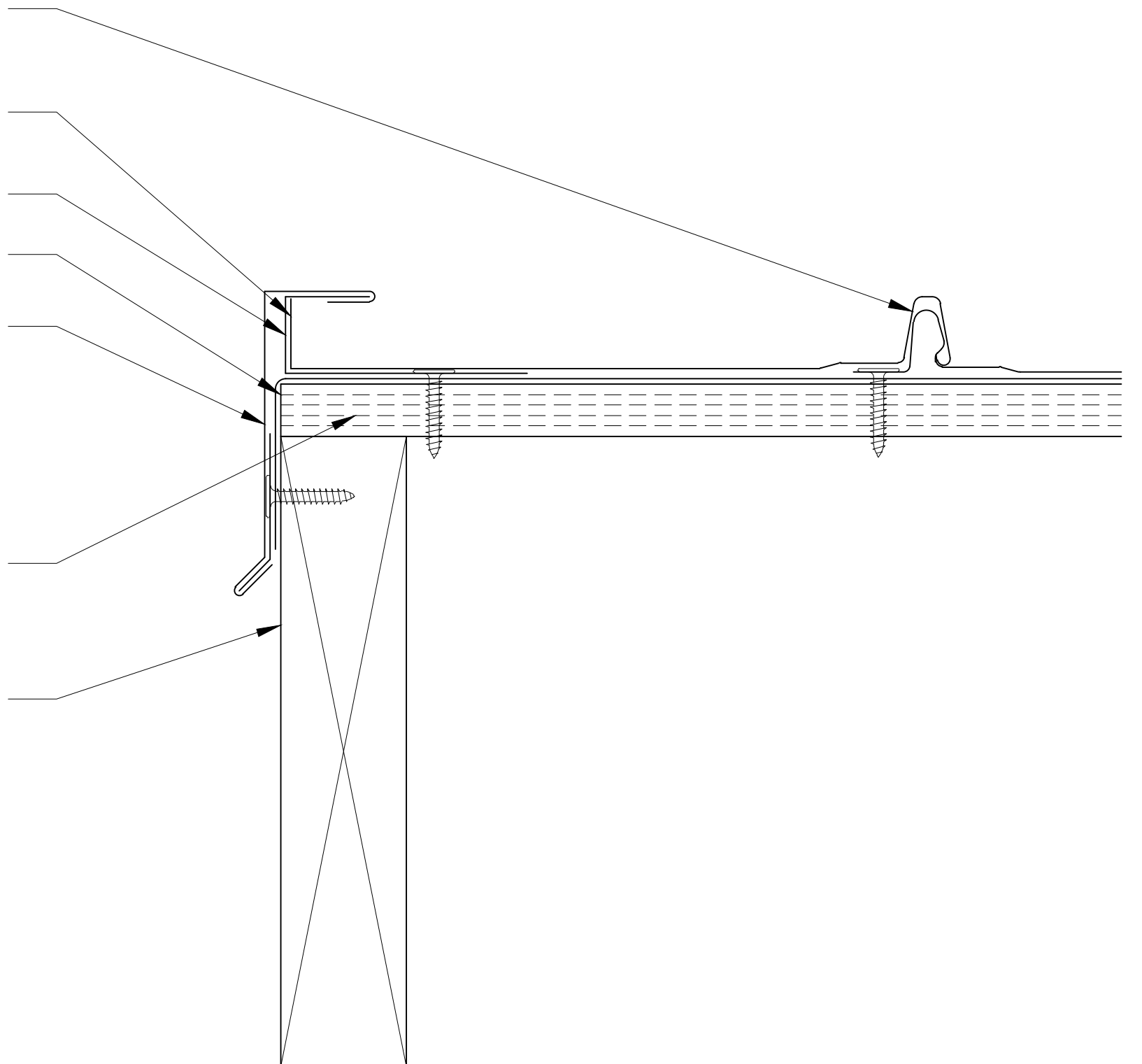

PAC CLAD  
 PETERSEN ALUMINUM CORPORATION  
 102 NORTHPOINT PARKWAY, BLDG 102  
 ACWORTH, GA 30102  
 PH: 77-0427-6378 FAX: 770-420-2533

JOB

# EDGE LOC PANEL

DETAIL

## GABLE SECTION STANDARD

SCALE N.T.S.	ARCH REFERENCE N/A
FILE # DLT	DATE 04 DEC 2013

SHEET

# A7

EDGE LOC ROOF PANEL. FASTEN THROUGH SCREW SLOTS USING APPROPRIATE FASTENERS FOR THE UNDERLYING DECKING. DO NOT OVER-TORQUE SCREWS.

UNDERLAYMENT TO TURN DOWN FACE BEHIND CLEAT.

DECKING.

INSTALLER TO FIELD CUT PANEL TO WIDTH AS REQUIRED AND FOLD PANEL UNDER 180°. HOOK ON PANEL ON GABLE FLASHING.

GABLE FLASHING & CLEAT. FASTEN CLEAT TO FASCIA W/ SCREWS 12" OC MAX. HOOK GABLE FLASHING ON CLEAT AT BOTTOM & FASTEN TO DECKING AT TOP USING APPROPRIATE SCREWS 12" OC MAX.

FASCIA.

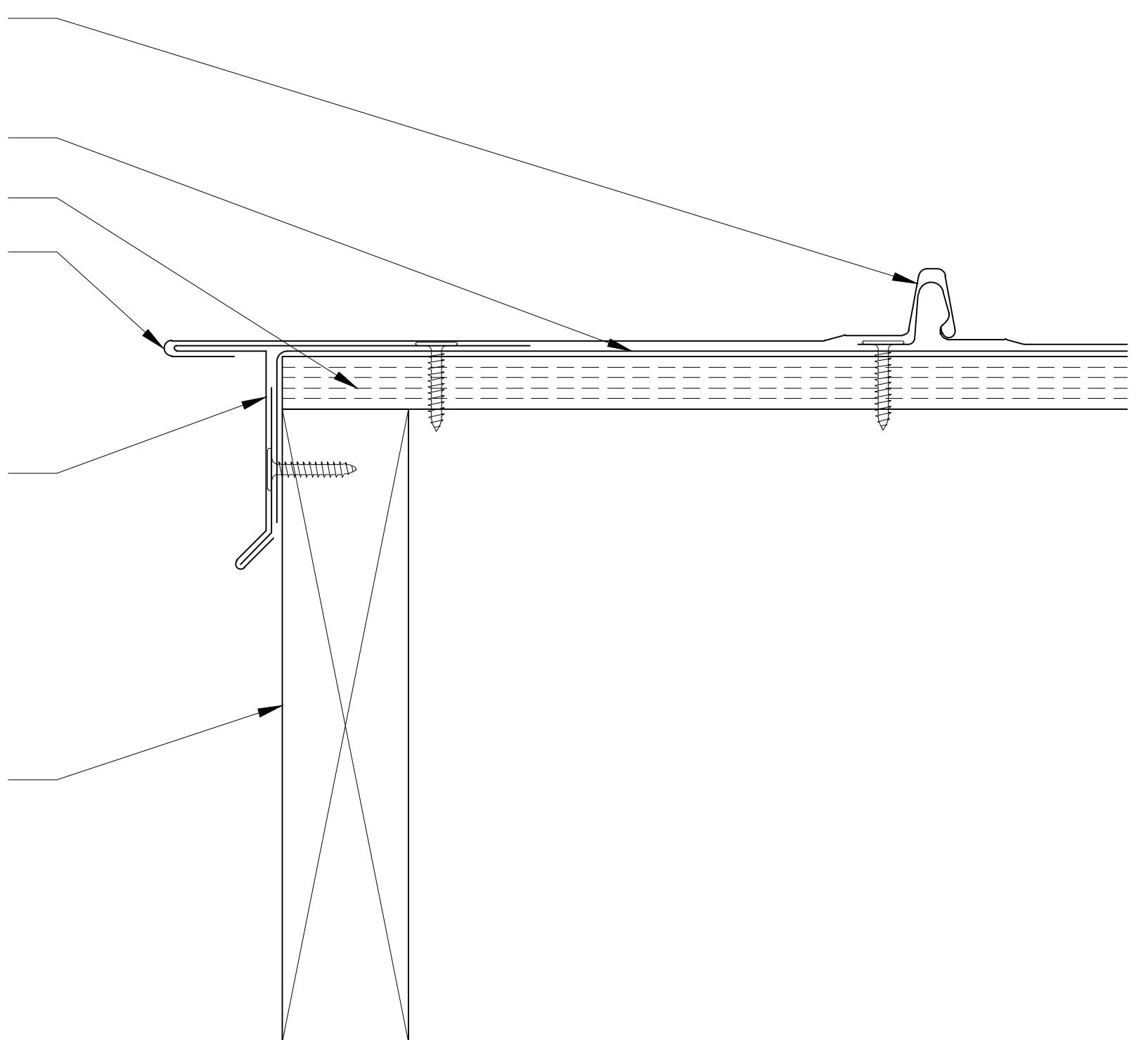

PAC CLAD  
 PETERSEN ALUMINUM CORPORATION  
 102 NORTHPOINT PARKWAY, BLDG 102  
 ACWORTH, GA 30102  
 PH: 77-0427-6378 FAX: 770-420-2533

JOB  
**EDGE LOC PANEL**

DETAIL	
GABLE SECTION ALTERNATE	
SCALE N.T.S.	ARCH REFERENCE N/A
FILE # DLT	DATE 04 DEC 2013

SHEET  
**A8**



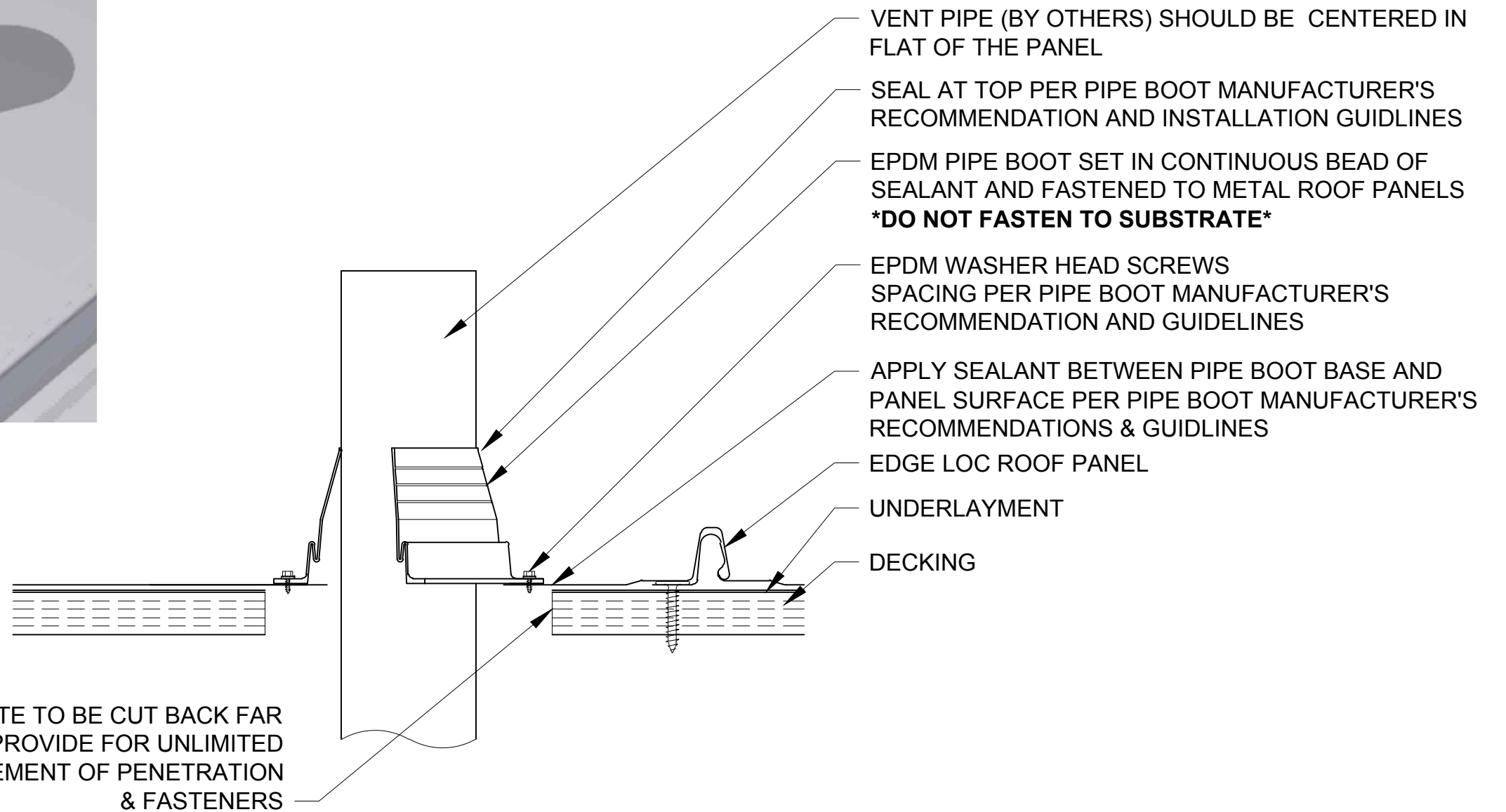
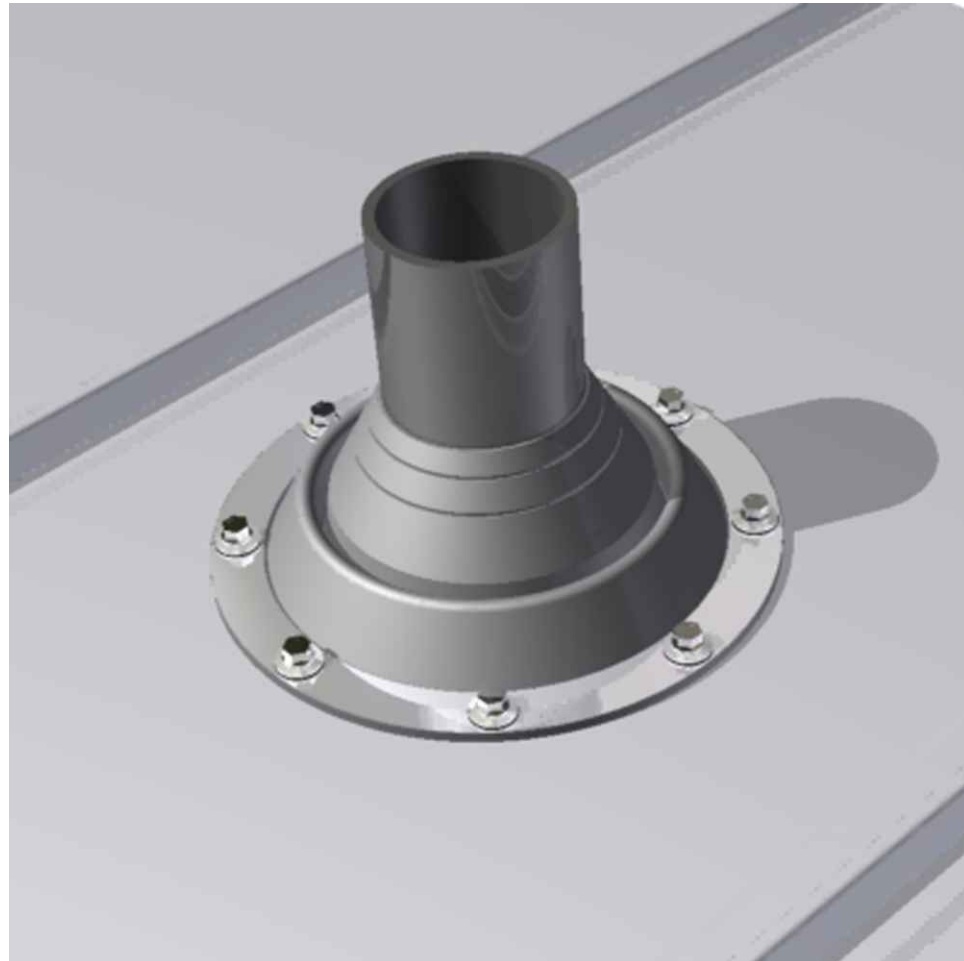

PAC CLAD  
PETERSEN ALUMINUM CORPORATION  
102 NORTHPOINT PARKWAY, BLDG 102  
ACWORTH, GA 30102  
PH: 77-0427-6378 FAX: 770-420-2533

JOB

# EDGE LOC PANEL

DETAIL	
VENT PIPE FLASHING DETAIL	
SCALE N.T.S.	ARCH REFERENCE N/A
FILE # DLT	DATE 04 DEC 2013

SHEET

# A9